

## Crimp-Rast-Stift-/Buchsenleisten RM 2,00mm, gerade/gewinkelt Friction Lock Headers / Crimp-Housings, 2.00mm Pitch, Straight/Right-Angled

### Technische Daten / Technical Data

Isolierkörper <i>Insulator</i>	Thermoplast, nach UL94 V-0, halogenfrei <i>Thermoplastic, UL94 V-0, halogen-free</i>
Farbe <i>Colour</i>	Weiß / natur <i>White / natural</i>
Kontaktmaterial <i>Contact Material</i>	Vierkantstift 0,50mm, Kupferlegierung <i>Square pin 0.50mm, copper alloy</i>
Aderquerschnitt <i>Applicable wire Gauge</i>	AWG 28 ~ 22 <i>AWG 28 ~ 22</i>
Durchgangswiderstand <i>Contact Resistance</i>	< 20 mΩ <i>&lt; 20 mΩ</i>
Isolationswiderstand <i>Insulation Resistance</i>	> 1000 MΩ <i>&gt; 1000 MΩ</i>
Spannungsfestigkeit <i>Test Voltage</i>	800 V AC <i>800 V AC</i>
Nennspannung <i>Voltage Rating</i>	250 V AC/DC <i>250 V AC/DC</i>
Nennstrom <i>Current Rating</i>	3 A <i>3 A</i>
Temperaturbereich <i>Temperature Range</i>	-25 °C ... +105 °C <i>-25 °C ... +105 °C</i>
Verarbeitung <i>Processing</i>	Wellenlötverfahren <i>Wave soldering</i>

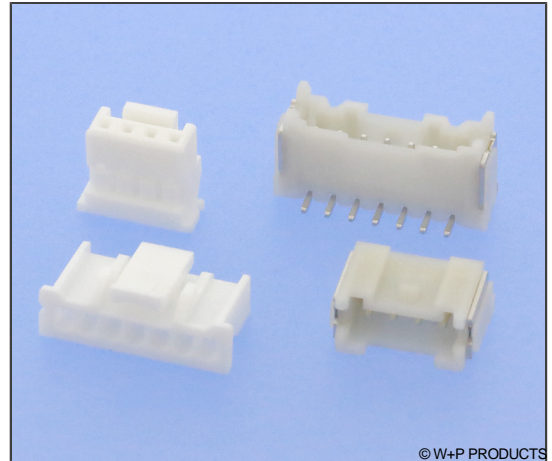

© W+P PRODUCTS

Buchsenhäuse passt auch zur Serie:  
*Housing mates also with Series:*  
**5490**

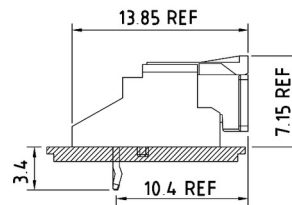
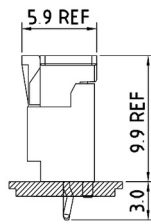
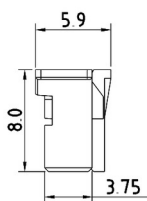
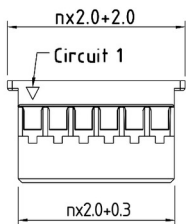
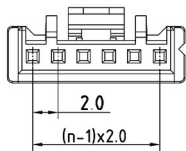

### Series

**549**

### Contacts

**06**

02-11  
Weitere Polzahlen auf Anfrage  
*More contacts on request*

### Type

**1**

1 Buchsenhäuse  
*Female Header*

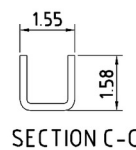
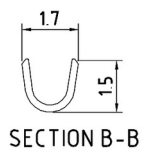
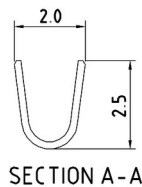
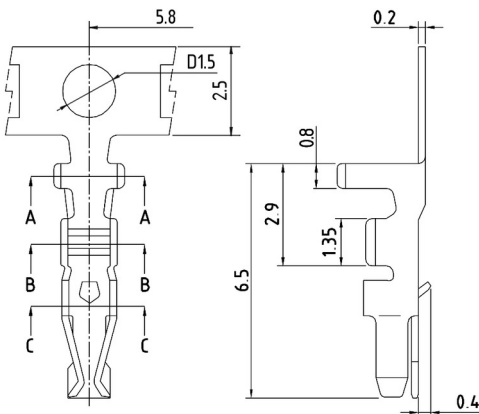

### Series

**549**

### Contacts

**01**

### Type

**2**

2 Crimp-Buchsenkontakt  
*Crimp terminal female*

### Plating

**50**

50 Sn

# 549

## Crimp-Rast-Stift-/Buchsenleisten RM 2,00mm, gerade/gewinkelt Friction Lock Headers / Crimp-Housings, 2.00mm Pitch, Straight/Right-Angled

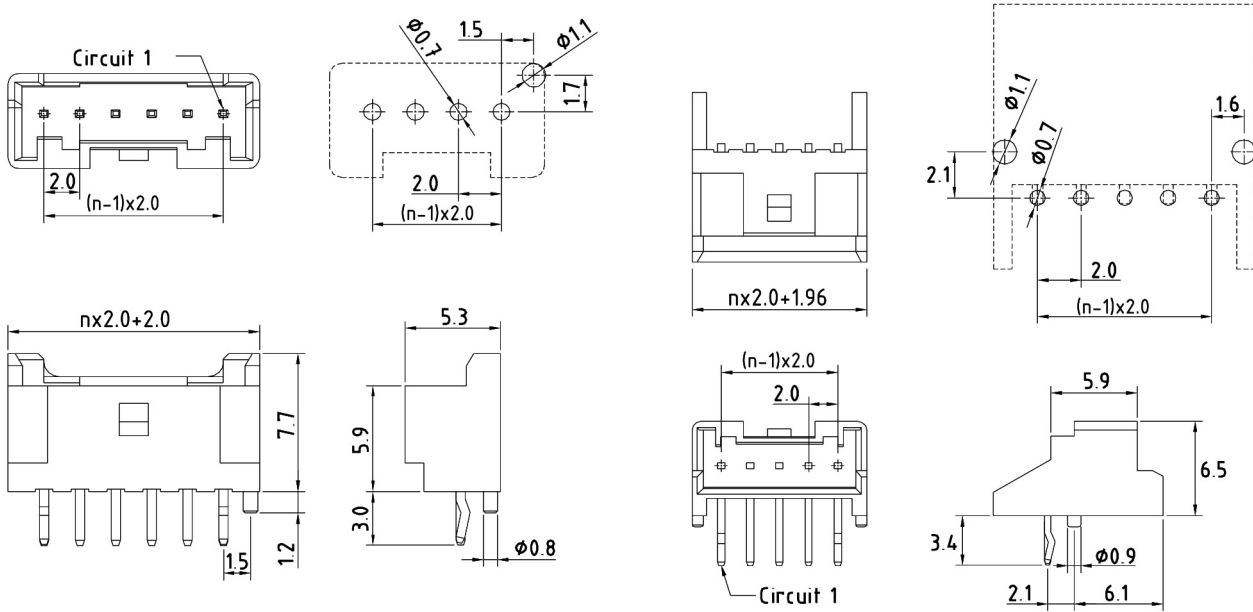

Series

**549**

Contacts\*

**05**

02-11  
Weitere Polzahlen auf Anfrage  
More contacts on request

Type\*

**3**

3 Stiftleiste gerade  
Pin Header straight  
4 Stiftleiste gewinkelt  
Pin Header right-angled

Plating

**50**

50 Sn

\* Dies ist ein **Bestellbeispiel** -  
bitte durch Ihre Spezifikationen ersetzen.  
\* This is an **order example** -  
please replace by your specifications.

### Empfehlungen für das Wellenlötverfahren

#### Recommendations for Wave Soldering

Die Bauteile sollten bei einer Lötbadtemperatur von 260°C in max. 5 Sekunden verlötet werden.

Empfohlenes Wellenlötprofil:

