

#### Technische Daten / Technical Data:

Isolierkörper	Thermoplastischer Kunststoff, nach UL94V0
Insulator	Thermoplastic, rated UL94V0
Kontaktmaterial	Messing, verzinkt
Contact Material	Brass, tin plated
Kabeldurchmesser	AWG 28-32
Applicable wire	AWG 28-32
Lötbarkeit	IEC512-12A
Solderability	IEC512-12A
Durchgangswiderstand	≤ 20 mOhm
Contact Resistance	≤ 20 mOhm
Isolationswiderstand	> 10 <sup>9</sup> Ohm
Insulation Resistance	> 10 <sup>9</sup> Ohm
Spannungsfestigkeit	800 V <sub>AC</sub>
Test Voltage	800 V <sub>AC</sub>
Nennspannung	100 V <sub>AC/DC</sub> max.
Current Voltage	100 V <sub>AC/DC</sub> max.
Nennstrom	1 A
Current Rating	1 A
Temperaturbereich	-25°C...+85°C
Temperature Range	-25°C...+85°C
Verarbeitung	Wellen-Lötverfahren; weitere Informationen in Kapitel T
Processing	Wave-Soldering, further informations in chapter T

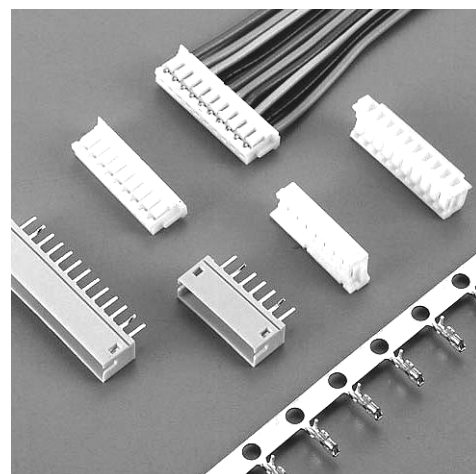

© W+P PRODUCTS

#### Housing

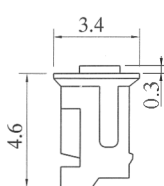
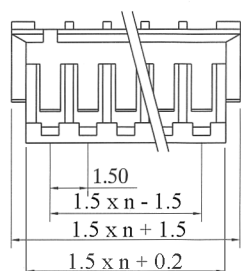

n = Anzahl Kontakte  
n = No. of Contacts

#### Header

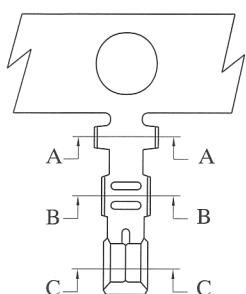
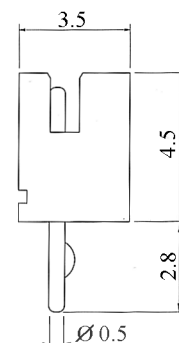
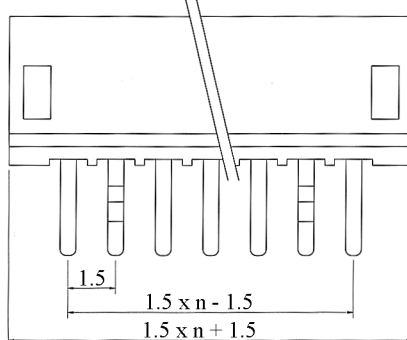

#### Contact

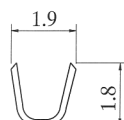
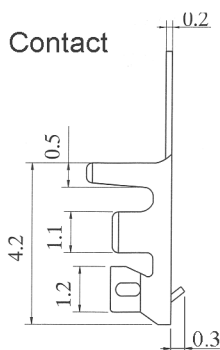

SEC A-A

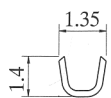

SEC B-B

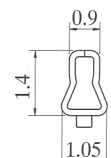

SEC C-C

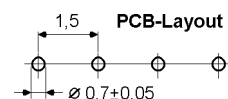

**K**

#### Series

**569**

#### Contacts\*

**13**

02-13-pol.

#### Type\*

**3**

1 = Buchsengehäuse  
Housing  
2 = Buchsenkontakte  
Crimp-Contacts  
3 = Stiftleiste gerade  
Pin Header Straight

#### Plating

**50**

50 = verzinkt  
tin plated

keine Angabe bei Gehäusen  
Not Necessary for Housings

(\* Bestellbeispiel - Bitte durch Ihre Spezifikationen ersetzen.)

\* Order example - To be replaced by your specifications.)

## Wellen-Lötverfahren Wave-Soldering

Bauteile sollten bei 260°C für max. 5 Sekunden verarbeitet werden.  
*Items should be soldered at 260°C for max. 5 seconds.*

Empfohlenes Wellen-Lötprofil:  
*Recommended Wave-Soldering profile:*

