

#### Technische Daten / Technical Data:

Gehäuse <i>Shell</i>	Stahl vernickelt, verzinkt <i>steel, tin coated over nickel</i>
Isolierkörper <i>Insulator</i>	Thermoplastischer Kunststoff, nach UL94V0 <i>Thermoplastic, rated UL94V0</i>
Kontaktmaterial <i>Contact Material</i>	Kupferlegierung <i>copper alloy</i>
Kontaktoberfläche <i>Contact Surface</i>	Gold über Nickel <i>gold plated over nickel</i>
Lötbarkeit <i>Solderability</i>	IEC512-12A <i>IEC512-12A</i>
Durchgangswiderstand <i>Contact Resistance</i>	≤ 10 mOhm <i>≤ 10 mOhm</i>
Isolationswiderstand <i>Insulation Resistance</i>	> 10 <sup>9</sup> Ohm <i>&gt; 10<sup>9</sup> Ohm</i>
Spannungsfestigkeit <i>Test Voltage</i>	1000 V <sub>AC</sub> <i>1000 V<sub>AC</sub></i>
Nennstrom <i>Current Rating</i>	3 A <i>3 A</i>
Temperaturbereich <i>Temperature Range</i>	-55°C...+125°C <i>-55°C...+125°C</i>
Verarbeitung <i>Processing</i>	Wellen-Lötverfahren; weitere Informationen in Kapitel T <i>Wave-Soldering, further informations in chapter T</i>



© W+P PRODUCTS

C

Stift / Male

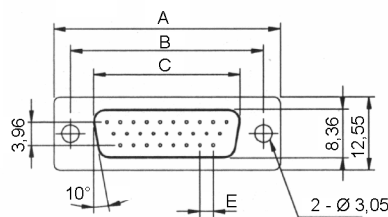

Buchse / Female

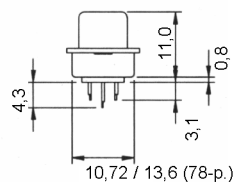
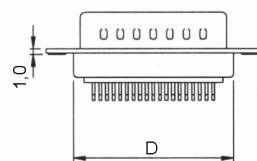
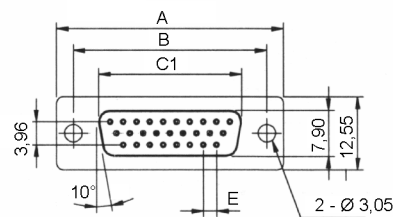

Dimensions (mm)						
Contacts	A	B	C	C1	D	E
15	30,80	25,00	16,90	16,30	19,30	2,30
26	39,10	33,30	25,30	24,70	27,50	2,30
44	53,00	47,00	38,30	37,70	41,00	2,30
62	69,30	63,50	55,40	54,80	57,70	2,40
78	66,90	61,10	52,90	52,30	55,30	2,40

**Series**

**Contacts\***

**Terminal\***

**Quality**

**Mounting\***

108

44

1

3

0

15/26/44/62/78-pol.

1 = Stift  
*male*  
2 = Buchse  
*female*

**GK 3** = min. 50 Steckzyklen  
andere GK auf Anfrage  
*min. 50 cycles, other qualities upon Request*

laut Übersicht Seite C31  
*see options on page C31*

(\* Bestellbeispiel - Bitte durch Ihre Spezifikationen ersetzen.)

\* Order example - To be replaced by your specifications.)

TEL.: +49 5223 98507-0  
FAX : +49 5223 98507-50

**W+P PRODUCTS**

E-MAIL: sales@wpro.com  
INTERNET: www.wpro.com

## Wellen-Lötverfahren Wave-Soldering

Bauteile sollten bei 260°C für max. 5 Sekunden verarbeitet werden.  
*Items should be soldered at 260°C for max. 5 seconds.*

Empfohlenes Wellen-Lötprofil:  
*Recommended Wave-Soldering profile:*



# D-SUB-Steckverbinder - Befestigungsoptionen

*D-SUB-Connector - Mounting Options*

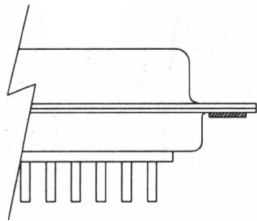

Durchgangsloch 3,05 mm  
*through hole 3,05 mm*

**Code: 0**

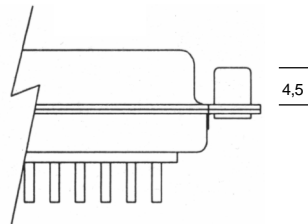

Gewindeniet UNC 4-40  
*UNC 4-40 thread rivet*  
Gewindeniet M3  
*M 3 thread rivet*

**Code: B1**

**Code: B2**

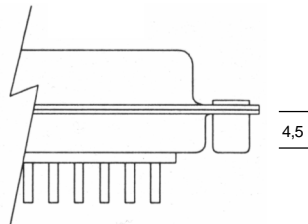

Gewindeniet UNC 4-40  
*UNC 4-40 thread rivet*  
Gewindeniet M3  
*M 3 thread rivet*

**Code: 1**

**Code: 2**

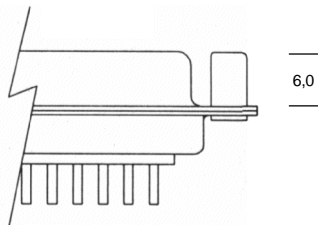

Gewindebolzen UNC 4-40  
*UNC 4-40 thread bolts*  
Gewindebolzen M3  
*M 3 thread bolts*

**Code: 3**

**Code: 4**

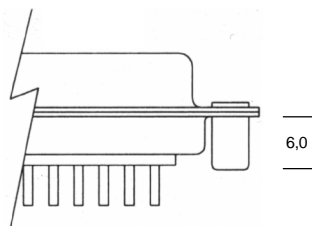

Gewindebolzen UNC 4-40  
*UNC 4-40 thread bolts*  
Gewindebolzen M3  
*M 3 thread bolts*

**Code: 5**

**Code: 6**

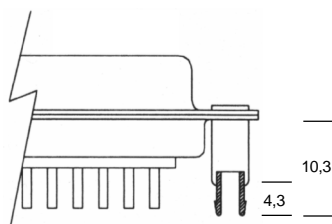

Boardlock mit UNC 4-40 Gewinde  
*boardlock type with UNC 4-40 thread*

**Code: BL**

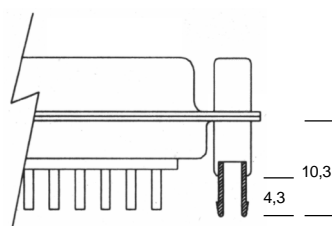

Combilock mit UNC 4-40 Gewinde  
*combilock type with UNC 4-40 thread*

**Code: CL**