

Technische Daten / Technical Data

Gehäuse	Stahl vernickelt, verzinkt
Shell	Steel, tin coated over nickel
Isolierkörper	Thermoplastischer Kunststoff, nach UL94 V-0
Insulator	Thermoplastic, rated UL94 V-0
Kontaktmaterial	Kupferlegierung
Contact Material	Copper alloy
Kontaktoberfläche	Gold über Nickel
Contact Surface	Gold over nickel
Lötbarkeit	IEC 60512-12A
Solderability	IEC 60512-12A
Durchgangswiderstand	< 20mΩ
Contact Resistance	< 20mΩ
Isolationswiderstand	> 500MΩ
Insulation Resistance	> 500MΩ
Spannungsfestigkeit	500V _{AC}
Test Voltage	500V _{AC}
Nennstrom	3A
Current Rating	3A
Temperaturbereich	-55°C ... +125°C
Temperature Range	-55°C ... +125°C
Verarbeitung	Wellenlötverfahren
Processing	Wave soldering



© W+P PRODUCTS

PCB-Layouts s. tech. Informationen
PCB Layouts in Tech. Info

Stift / Male

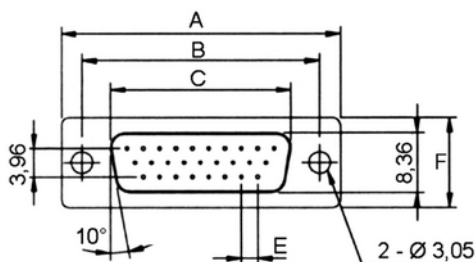

Buchse / Female

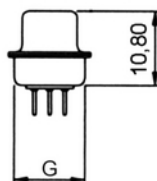
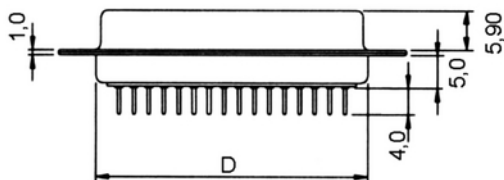
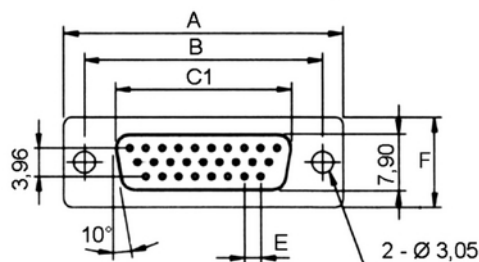

n	A	B	C	C1	D	E	F	G
15	30,80	24,99	16,92	16,33	19,30	2,29	12,55	10,72
26	39,10	33,32	25,25	24,66	27,50	2,29	12,55	10,72
44	53,00	47,04	38,25	37,66	41,03	2,29	12,55	10,72
62	69,30	63,50	55,42	54,84	57,70	2,41	12,55	10,72
78	66,90	61,11	52,86	52,34	55,30	2,41	15,40	13,60

Series	Contacts*	Terminal*	Quality	Mounting*
109	15	2	3	0
	15/26/44/62/78	1 Stift Male 2 Buchse Female	GK 3 >50 Steckzyklen, andere GK auf Anfrage Min. 50 cycles, other quality classes by request	0 ... CL Lt. Tech. Info. See Tech. Info.

* Dies ist ein **Bestellbeispiel** - bitte durch Ihre Spezifikationen ersetzen.
* This is an **order example** - please replace by your specifications.

TEL +49 5223 98507-0
FAX +49 5223 98507-50

W+P PRODUCTS

E-MAIL sales@wppro.com
WEBSITE www.wppro.com

Leiterplatten-Layouts für HD D-Sub-Verbinder

PCB Layouts for HD-D-Sub Connectors

Gerade Ausführung / Straight Type

Stift / Male

Buchse / Female

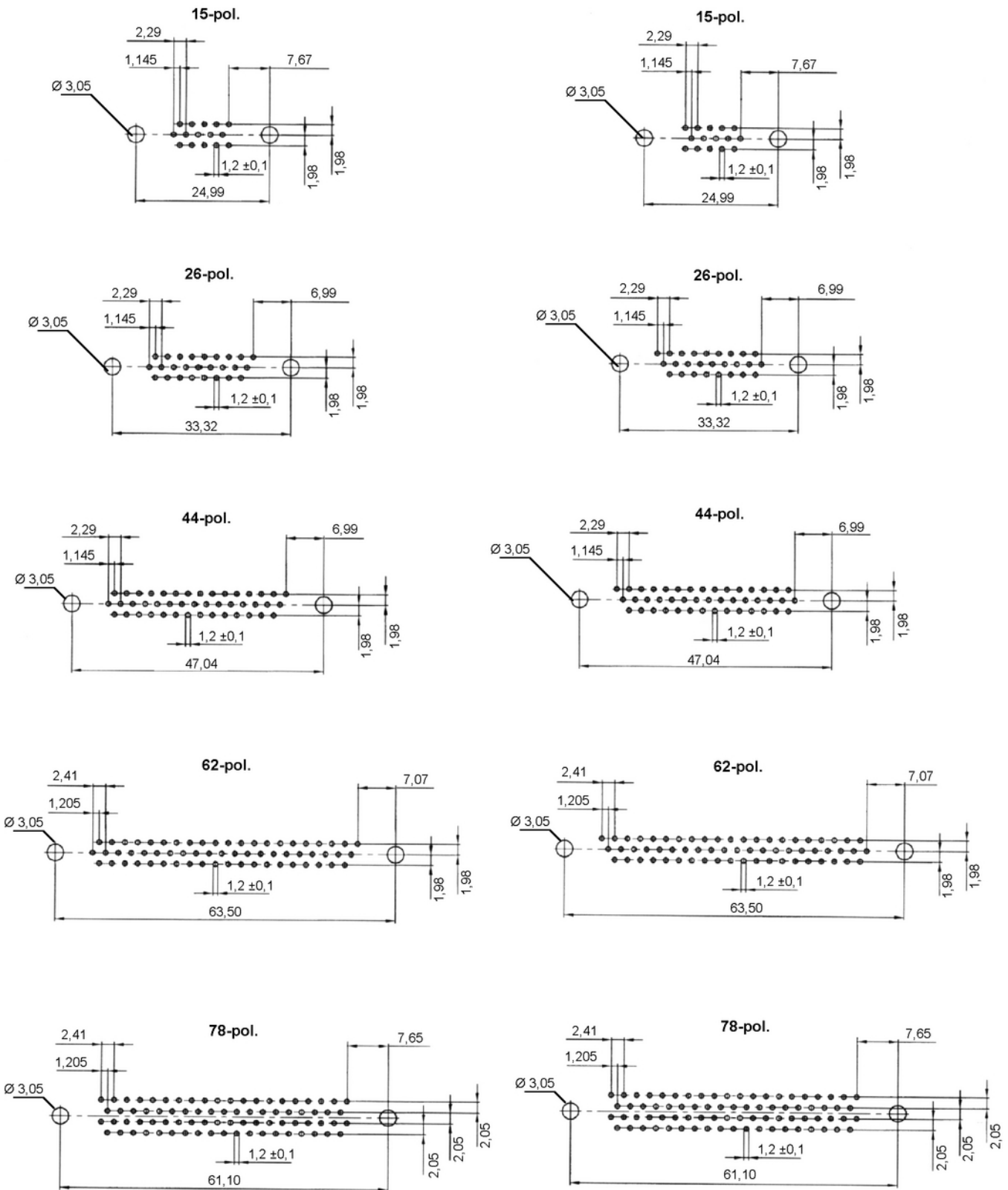

Gewinkelte Ausführung / Right-angled Type

Stift / Male

Buchse / Female

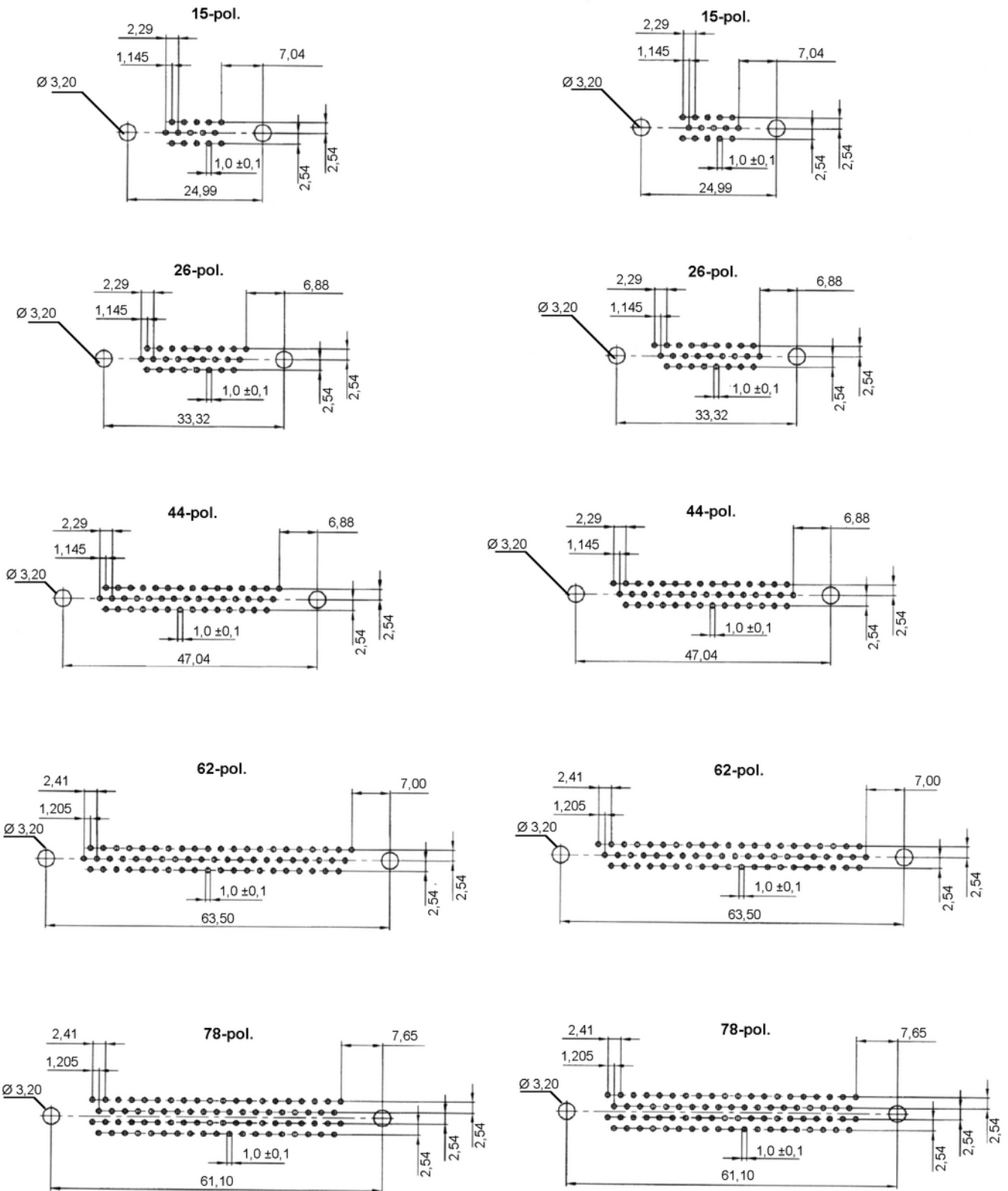

Befestigungsoptionen Mounting Options

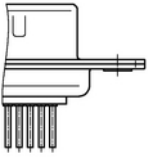

0 Durchgangsloch 3,05mm
3.05mm Through Hole

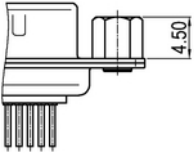

B1 Gewindeniet UNC 4-40
UNC 4-40 Thread Rivet

B2 Gewindeniet M3
M3 Thread Rivet

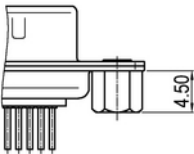

1 Gewindeniet UNC 4-40
UNC 4-40 Thread Rivet

2 Gewindeniet M3
M3 Thread Rivet

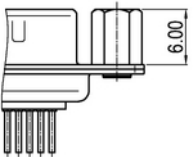

3 Gewindebolzen UNC 4-40
UNC 4-40 Thread Bolt

4 Gewindeniet M3
M3 Thread Rivet

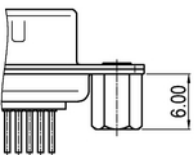

5 Gewindebolzen UNC 4-40
UNC 4-40 Thread Bolt

6 Gewindebolzen M3
M3 Thread Bolt

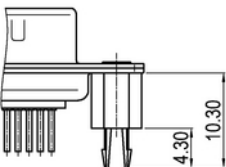

BL Board Lock mit UNC 4-40 Gewinde
Board Lock with UNC 4-40 Thread

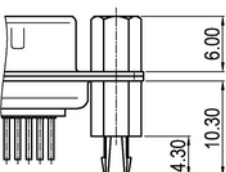

CL Combi-Lock mit UNC 4-40 Gewinde
Combi Lock with UNC 4-40 Thread

Empfehlungen für das Wellenlötverfahren

Recommendations for Wave Soldering

Die Bauteile sollten bei einer Lötbadtemperatur von 260°C in max. 5 Sekunden verlötet werden.

Items should be soldered at a solder temperature of 260°C in 5 seconds max.

Empfohlenes Wellenlötprofil:

Recommended wave soldering profile:

