

Technische Daten / Technical Data

Gehäuse	Stahl vernickelt, verzinkt
Shell	Steel, tin coated over nickel
Isolierkörper	Thermoplastischer Kunststoff, nach UL94 V-0
Insulator	Thermoplastic, rated UL94 V-0
Kontaktmaterial	Kupferlegierung
Contact Material	Copper alloy
Kontaktoberfläche	Gold über Nickel
Contact Surface	Gold over nickel
Lötbarkeit	IEC 60512-12A
Solderability	IEC 60512-12A
Durchgangswiderstand	< 20mΩ
Contact Resistance	< 20mΩ
Isolationswiderstand	> 500MΩ
Insulation Resistance	> 500MΩ
Spannungsfestigkeit	500V _{AC}
Test Voltage	500V _{AC}
Nennstrom	3A
Current Rating	3A
Temperaturbereich	-55°C ... +125°C
Temperature Range	-55°C ... +125°C



© W+P PRODUCTS

Stift / Male

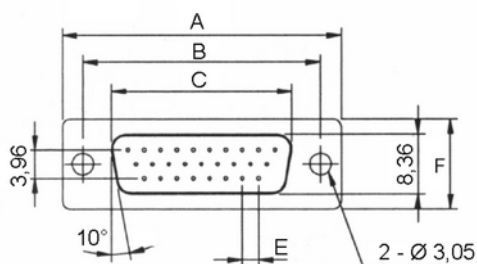

Buchse / Female

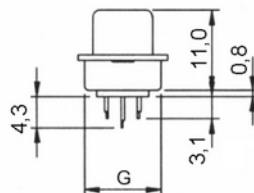
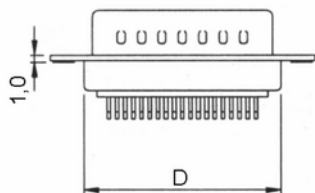
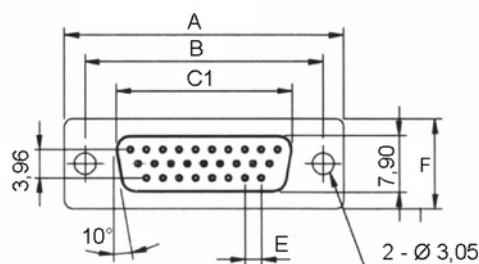

n	A	B	C	C1	D	E	F	G
15	30,80	25,00	16,90	16,30	19,30	2,30	12,55	10,72
26	39,10	33,30	25,30	24,70	27,50	2,30	12,55	10,72
44	53,00	47,00	38,30	37,70	41,00	2,30	12,55	10,72
62	69,30	63,50	55,40	54,80	57,70	2,40	12,55	10,72
78	66,90	61,10	52,90	52,30	55,30	2,40	15,20	13,60

Series

108

Contacts*

44

15/26/44/62/78

Terminal*

1

1 Stift
Male
2 Buchse
Female

Quality

3

GK 3 >50 Steckzyklen, andere GK auf Anfrage
Min. 50 cycles, other quality classes by request

Mounting*

0

0 ... CL Lt. Tech. Info.
See Tech. Info.

* Dies ist ein **Bestellbeispiel** -
bitte durch Ihre Spezifikationen ersetzen.
* This is an **order example** -
please replace by your specifications.

Befestigungsoptionen Mounting Options

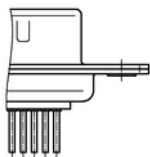

0 Durchgangsloch 3,05mm
3.05mm Through Hole

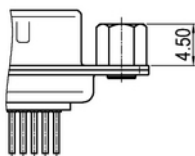

B1 Gewindeniet UNC 4-40
UNC 4-40 Thread Rivet

B2 Gewindeniet M3
M3 Thread Rivet

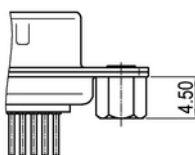

1 Gewindeniet UNC 4-40
UNC 4-40 Thread Rivet

2 Gewindeniet M3
M3 Thread Rivet

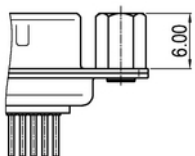

3 Gewindebolzen UNC 4-40
UNC 4-40 Thread Bolt

4 Gewindeniet M3
M3 Thread Rivet

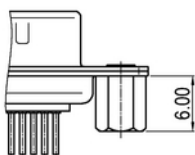

5 Gewindebolzen UNC 4-40
UNC 4-40 Thread Bolt

6 Gewindebolzen M3
M3 Thread Bolt

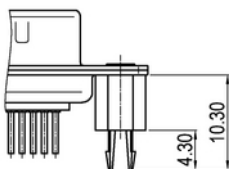

BL Board Lock mit UNC 4-40 Gewinde
Board Lock with UNC 4-40 Thread

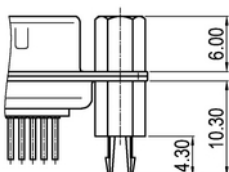

CL Combi-Lock mit UNC 4-40 Gewinde
Combi Lock with UNC 4-40 Thread